

ZINTL®



PREMIUM INTERLOCKING
ALUMINIUM CLADDING SYSTEM

DESIGN PERFORMANCE



Zintl® aluminium cladding system is a timelessly elegant and enduring material that offers a world of design possibilities. This high-performance cladding is available in a range of interlocking weatherboard profiles to suit any project.

Zintl® provides architects with facade profiles that are versatile and 100% non-combustible, certified to AS1530.1. Combining sophisticated style, extraordinary fire performance and efficient installation, this cladding system is ideal for residential, commercial, education, sporting and health care projects. Designed for quick and cost effective installation, Zintl® requires minimal ongoing maintenance and can be customised to suit each project.

Zintl® aluminium cladding is offered in a wide range of Interpon and Dulux powder coated finishes as well as a selection of anodised and wood grain architectural finishes, providing a beautifully refined aesthetic. With its mix of natural, bold and subtle hues, Zintl® is perfect for any budget or environment. Its durability makes it particularly well suited for coastal properties and high traffic areas.

ZINTL® BENEFITS

Customisable

With its six unique profile designs and broad range of finishes and colours, Zintl® enhances any project.

100% non-combustible to AS1530.1

Zintl® is NCC compliant, a rating that helps streamline the building approvals process.

Easy to install

Zintl®'s interlocking system is easy to use, which means faster installation, improved site costs and superb alignment.

Powder coated finish

Zintl® offers high colour retention and a superior long-lasting finish through trusted Interpon and Dulux ranges.

High quality marine grade aluminium

Zintl® is designed to be corrosion resistant, ensuring it will not oxidise over time and making it an ideal choice for all locations.

Competitively priced

Zintl® is an affordable and high-quality cladding option.

Stocked in Australia

As Zintl® is stocked locally, there are reduced lead times for delivery.

Expert advice

Zintl® offers a team of experts with strong industry, design and technical knowledge available to assist with enquiries.

Warranties

Zintl® surface finish warranties up to 30 years, based on powder coat range. Project warranties available with pre-approval.

ZINTL® TECHNICAL DATA SHEET

Properties	Units	Values
Alloy		6063
Temper		T5
Standard thickness	mm	1.4 - 2.2
Painted weight	kg/m ²	0.642kg/m to 1.575kg/m
Raw density	kg/m ³	2700
Young's modulus (E)	GPa	68.3
Tensile strength (25°C)	MPa	220
Yield strength (25°C)	MPa	180
Shear strength	MPa	11
Fatigue strength	MPa	117
Elastic modulus	MPa	69
0.2% proof stress	MPa	>170
Elongation	%	12
Linear thermal expansion		2.4mm/m at 100° temperature difference
Melting range	°C	630-660
Electrical conductivity - Equal volume	MS/m	32
Electrical conductivity - Equal mass	MS/m	105
Thermal conductivity	W/m.K	201-218
Sound adsorption factor	NCR	0.05
Sound reflection	%	95

FIRE PERFORMANCE

Zintl® premium interlocking aluminium cladding system is certified non-combustible when tested to AS1530.1.

Properties	Result		
AS1530.1	Non-combustible		
AS1530.3	Pass	Ignitability index	0
	Pass	Heat evolved	0
	Pass	Spread of flame	0
	Pass	Smoke developed	3

ZINTL® SYSTEMS AND PROFILES



Shiplap 150

- 150mm finished face
- Horizontal and vertical install
- Contemporary, traditional weatherboard appearance
- 3.5m, 5.0m and 6.5m lengths



Step 60

- 120mm finished face
- Horizontal install only
- Stepped weatherboard appearance
- 3.5m, 5.0m and 6.5m lengths



Step 120

- 120mm finished face
- Horizontal install only
- Stepped weatherboard appearance
- 3.5m, 5.0m and 6.5m lengths





Linea 190

- 190mm finished face
- Horizontal and vertical install
- Sleek and contemporary flat board appearance
- 3.5m, 5.0m and 6.5m lengths



Shadow 200

- 200mm finished face
- Horizontal and vertical install
- A flat continuous board with negative detail
- 3.5m, 5.0m and 6.5m lengths



Standing Seam 190

- 190mm finished face
- Vertical install only
- A vertical interlocking profile with single standing seam
- 3.5m, 5.0m and 6.5m lengths



FIXING DETAILS

Horizontal Board

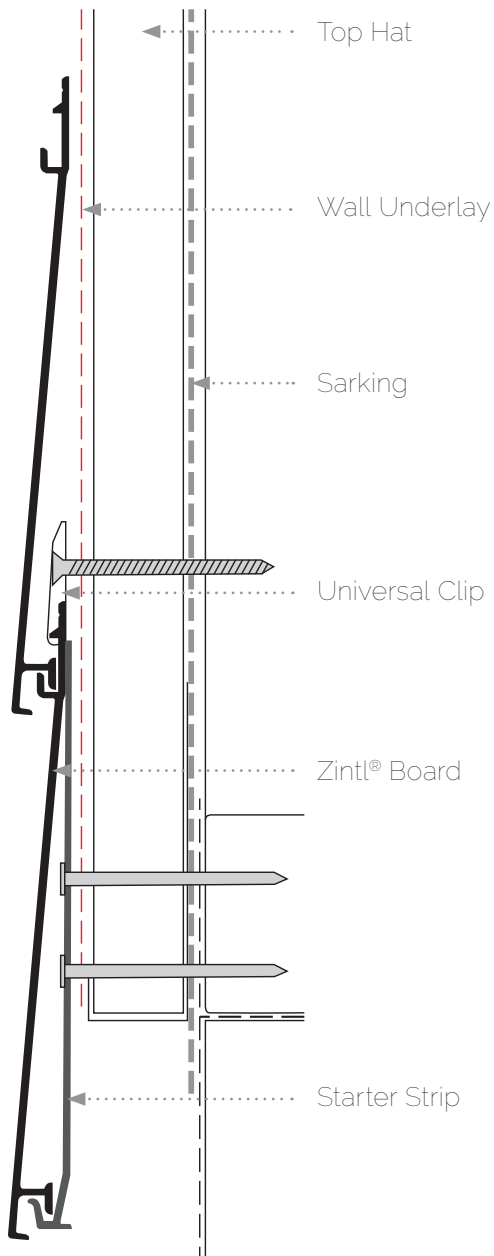

Vertical Board

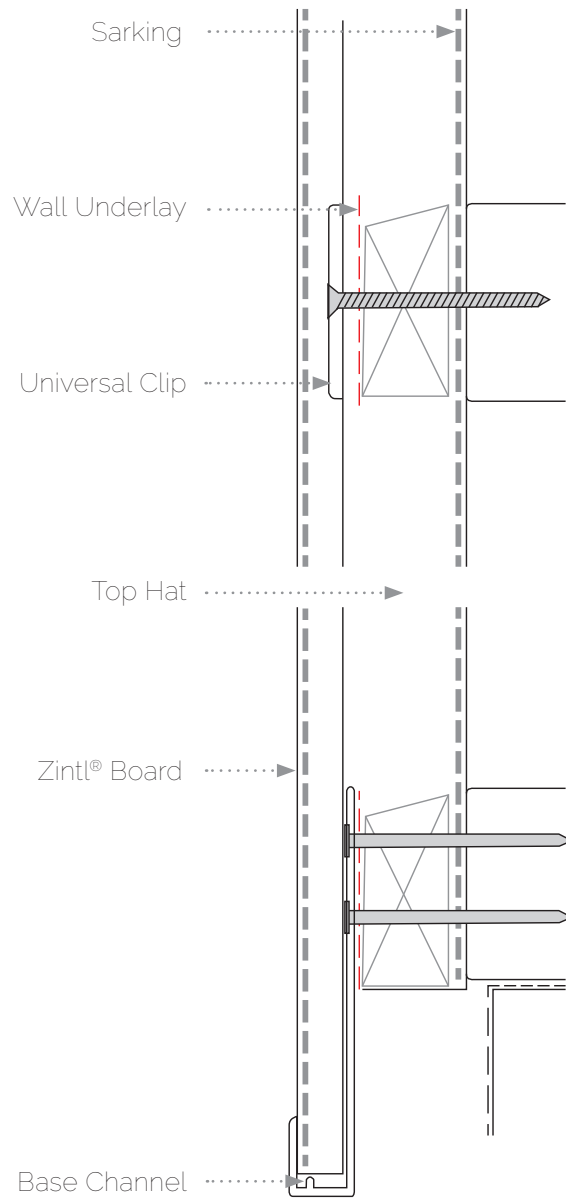

C L E A N I N G I N F O R M A T I O N

To ensure Zintl® is maintained to the highest standard, regular cleaning is recommended.

Further information can be found in the cleaning and maintenance brochures on the Interpon and Dulux websites.

Interpon link: <https://www.specifyinterpon.com.au/wp-content/uploads/interpon-care-and-maintenance.pdf>

Dulux Link: <https://duluxpowders.com.au/information/care-maintenance/>



A S U S T A I N A B L E C H O I C E

Zintl® aluminium cladding is an excellent choice to enhance the sustainability of buildings due to its exceptional corrosion resistance and recyclability.

Our Zintl® solid aluminium boards are 100% recyclable, offering an eco-friendly solution. Up to 95% less energy is required in the recycling of aluminium in comparison to other primary metals, ensuring a reduction in emissions.

ZINTL®



By **HVG** façades

hvgfacades.com.au | 1300 881 712

SYDNEY
29 Henderson Street
Turrella NSW 2205

MELBOURNE
25 West Park Drive
Derrimut VIC 3026

BRISBANE
128 Mica Street
Carole Park QLD 4300

PERTH
72 Bushland Ridge
Bibra Lake WA 6163

ADELAIDE
57 Barnes Avenue
Marleston SA 5033